











*Speed and Comfort*









 Hallberg-Rassy

*Sail a classy Hallberg-Rassy*





*Lots of natural light*



 Hallberg-Rassy











*Optional wine cellar below the floor in the saloon*



*Accordion style curtains stowing upwards*



*Retractable 32 inch LED TV*

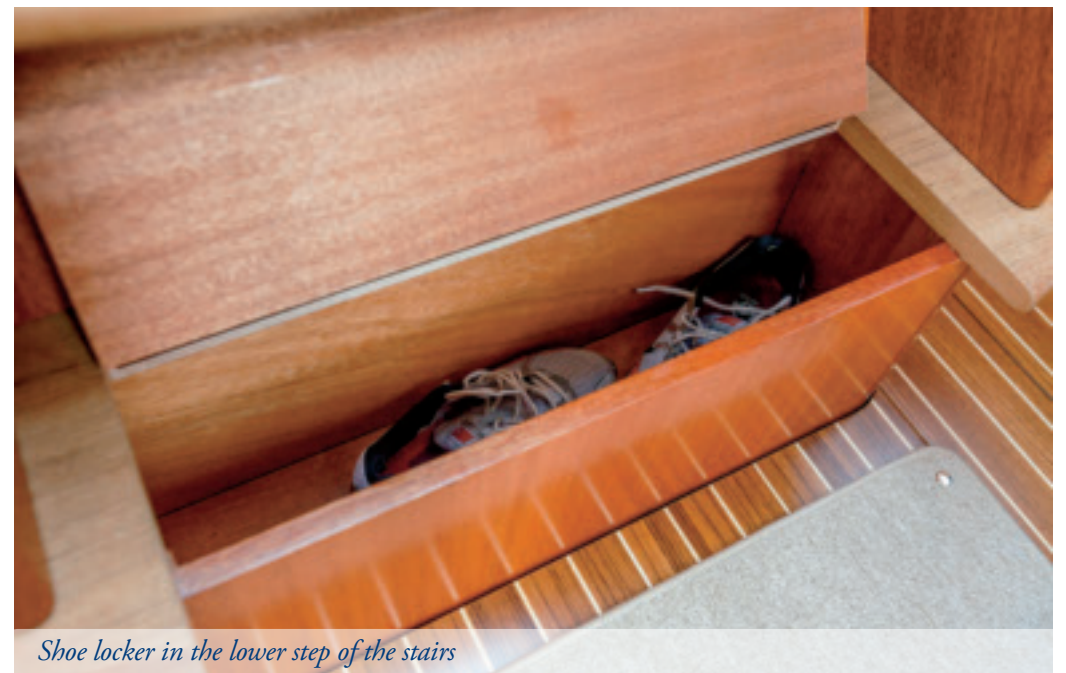

*Shoe locker in the lower step of the stairs*





*Big and double skylights, large opening side portlights, two hull portlights and white painted wooden panels in the alcoves bathe the interior in natural light*





*A powerful 75 HP Volvo Penta D2-75 engine*

**VOLVO  
PENTA**



*Wide and elegant stairs with built in shoe locker in the lower step*





*Bright and welcoming saloon*



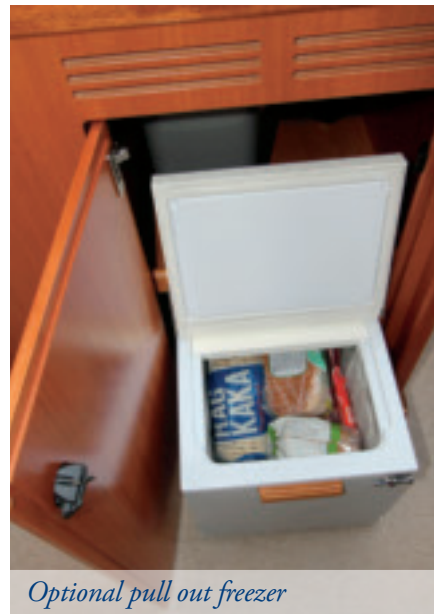
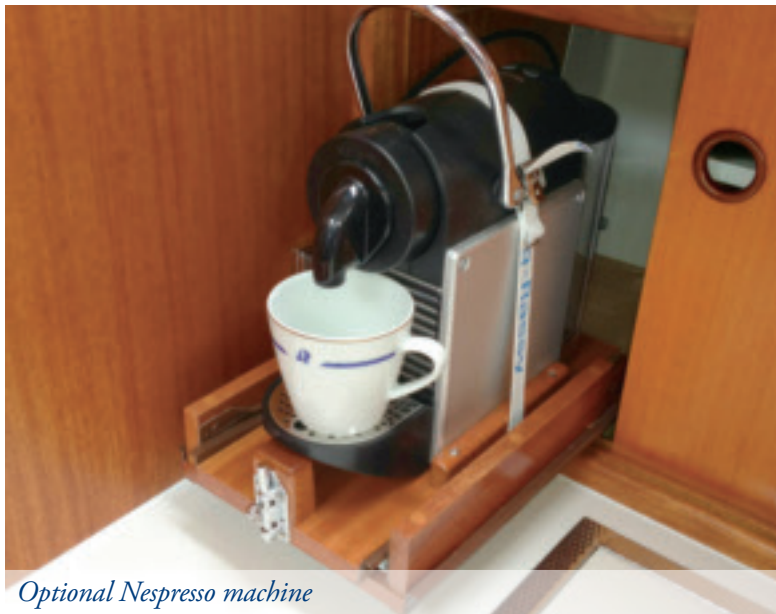





*Comfortable and seagoing galley*



*Aft head when combined with twin aft cabins*







*Large forward heads with separate shower with Plexi Glass doors and optional washing machine*



*Hull portlights in the aft cabins*



*Starboard side aft cabin*



*The port side aft cabin, with hull portlight, skylight and generous storage*





*Optional twin aft cabins*





*The V cabin in front*



*Elegant reading lights*



*The V cabin seen from aft*



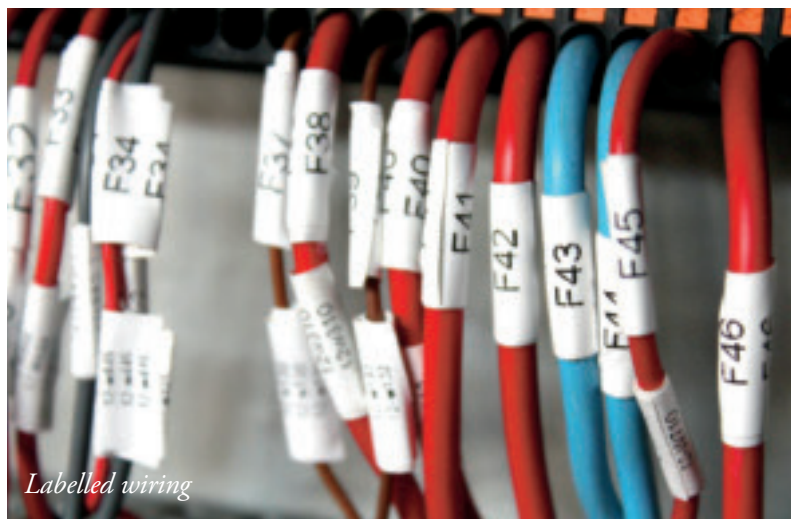

*Labelled wiring*



*Labelled through hull fittings with powerful valves*



*The inboard side of the work desk has a deep fiddle to retain moving objects, while the rear edge, where you rest your elbows, has no fiddle. The seat is nicely dished with is a useful bin on your right hand side*



*Rope bins to store halyard lines. Optional fixed cockpit table*



*The bathing platform with folding helmsman's seat and removable enclosing panels*



*Standard folding teak cockpit table*



*Powerful headsail foot blocks*

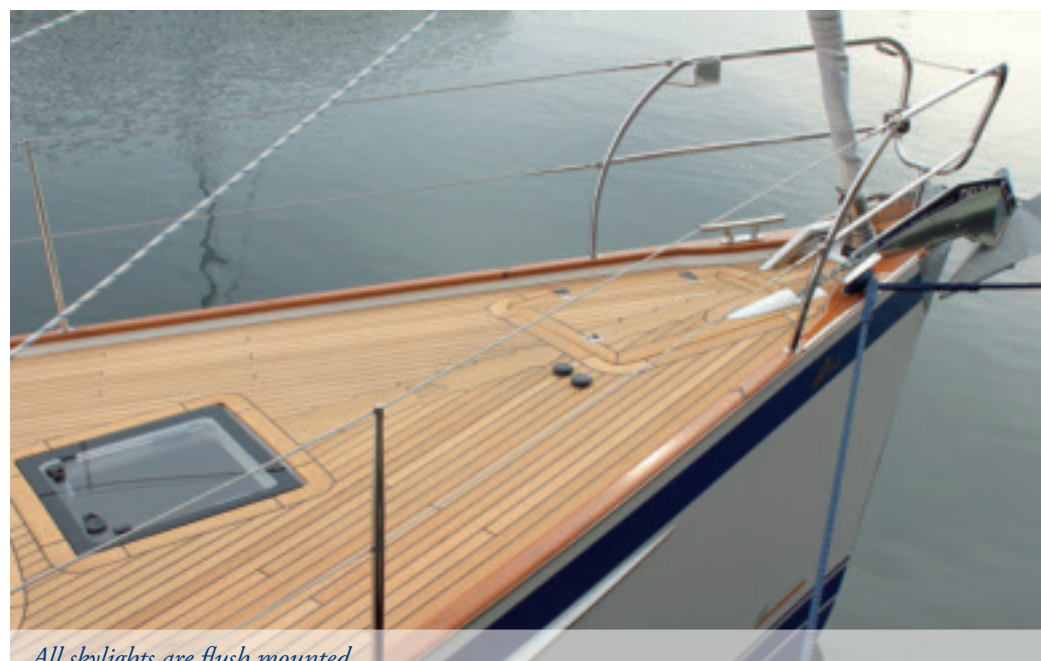

*All skylights are flush mounted.  
An anchor windlass and an electric Furlex foresail furler are mounted under deck*





*Elegant teak entrance, optionally high gloss varnished*



*Well dimensioned mooring cleats bolted with four bolts, on top of the teak toe rail. Integrated rubbing strake in the hull. Rainwater is drained below the waterline to avoid a dirty hull.*



*The upper part of the windscreen is curved. Wide sidedecks*



*The pedestal with the control of "everything", including bow- and stern thrusters, all four electric winches, the all-new 14 inch Furuno Time Zero Touch plotter, navigation lights, engine controls, anchor up and down, chain counter, stereo control and more*







# HALLBERG-RASSY 412

Design	Germán Frers
Hull length	12.61 m / 41' 5"
Beam	4.11 m / 13' 6"
Waterline at rest	11.50 m / 37' 9"
Draft at empty load	1.99 m * / 6' 7" *
Displacement, empty standard boat	11.1 t / 24 400 lbs
Keel weight	4.0 t / 8 830 lbs
Keel type	Lead on deep bilge
Sail area with main and 100% fore triangle	90 m <sup>2</sup> / 970 ft <sup>2</sup>
Sail area with main and code zero	130.9 m <sup>2</sup> / 1 410 ft <sup>2</sup>
Air draft, excl. Windex and antennas	19.65 m / 64' 6"
Engine	Volvo Penta D2-75
Power	55 kW / 75 HP
Cylinder volume	2.19 litres
Alternator	115 A
STIX	47
Diesel tanks	340 litres / 91 US gallon
Fresh water tanks	530 litres / 142 US gallon
Holding tanks	2 x 70 litres / 2 x 19 US gal.
CE category	A - Unlimited ocean voyages

Photos and texts show extra equipment. For more details please ask for our special Hallberg-Rassy 412 Standard Specification. There are a lot more photos and in-depth information on our website [www.hallberg-rassy.com](http://www.hallberg-rassy.com)



*One day you'll be glad it's a Hallberg-Rassy*

**HALLBERG-RASSY VARVS AB  
HALLBERG-RASSYVÄGEN 1  
SE-474 31 ELLÖS, SWEDEN**

**TEL +46-304-54 800**

**[www.hallberg-rassy.com](http://www.hallberg-rassy.com)**

**[www.facebook.com/hallberg-rassy](https://www.facebook.com/hallberg-rassy)**

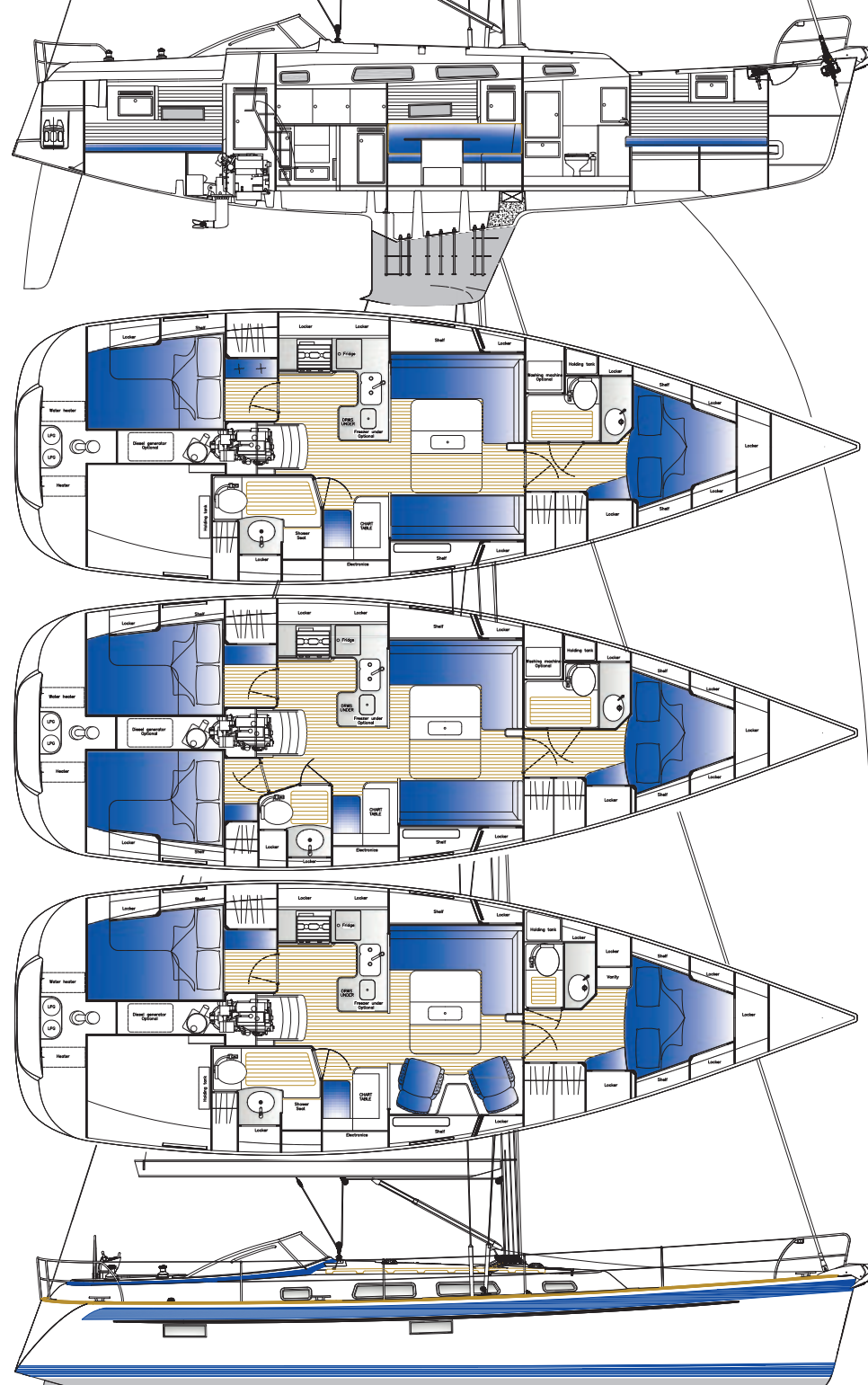





# R Hallberg-Rassy

HALLBERG-RASSY VARVS AB, HALLBERG-RASSYVÄGEN 1, SE-474 31 ELLÖS, SWEDEN  
 TEL +46-304-54 800 info@hallberg-rassy.se www.hallberg-rassy.com www.facebook.com/hallberg-rassy

ORIGINAL SPARE PARTS AND ACCESSORIES: HALLBERG-RASSY PARTS AB, Box 33, SE-474 21 ELLÖS, SWEDEN.  
 TEL +46 304 54 840. info@hr-parts.com

**ARGENTINA:** JOSÉ FRERS, RUBEN DARIO 3447 (1646) VICTORIA P.B.A.  
 TEL +54-11 47 45 05 37. jfrers@josefrers.com

**BULGARIA:** FINNINVEST LTD., BOKORIDY St No 59, BG-8000 BOURGAS.  
 TEL +359 (0) 56 845 107. finninv@bs.spnet.net

**CHILE:** MARES CHILE, NUEVA COSTANERA 3840 OFFICE 01, SANTIAGO.  
 TEL (56-2) 263 1000 info@mareschile.cl

**CROATIA:** MORE OCEAN D.O.O., HRGOVICI 95, HR-10000 ZAGREB.  
 TEL +385 98 48 38 54. marko@moreocean.hr

**DENMARK:** MARINEPARKEN YACHTS ApS, KAMPMANNSVEJ 29,  
 DK-7000 FREDERICIA TEL +45 20 18 41 91 bo@marineparken.dk

**FINLAND:** OY HELLMAN YACHTS AB, TAMMISTONTIE 256, FIN-20900 TURKU  
 TEL +358 (0)2 2581 600, +358 (0) 400 520 454. lassi.hellman@hellmarin.fi

**FRANCE:** LJB MARINE, RUE DE LA PERRUCH, GALERIE MARCHANDE DES MINIMES  
 46 AVENUE DU LAZARET, FR-17000 LA ROCHELLE. TEL : + 33 (0)5 46 52 19 52  
 MOBILE + 33 (0)6 22 88 13 80 info@ljb-marine.com

**GERMANY:** HALLBERG-RASSY DEUTSCHLAND GMBH, AN DER WIEK 7-15,  
 DE-23730 NEUSTADT. TEL 04561-55 86 48. info@hallberg-rassy.de

**HOLLAND:** NOVA YACHTING INTERNATIONAL BV, POSTBUS 15, NL-4310 AA  
 BRUINISSE. VISITING ADDRESS: JACHTHAVEN BRUINISSE, JACHTHAVENWEG 72,  
 NL-4311 NC BRUINISSE. TEL +31-111-48 18 10. info@nova-yachting.nl

**ITALY:** LIONS INT-YACHTS, VIA SALENTO 12, IT-00162 ROMA.  
 TEL 06-44 23 75 37. info@hallberg-rassy.it

**JAPAN:** GLOBAL MARINE INC., IMAZU BOAT CENTER 3F, 2-16 IMAZU-NISHIHAMA,  
 NISHINOMIYA, HYOGO 663-8225. TEL 0798-34-73 45. info@global-marine.co.jp

**NORWAY:** POLLEN MARITIME AS, BESØKSADRESSE: DRONNINGEN 1, OSLO.  
 POSTADRESSE: PB A BYGDØY, NO-0211 OSLO.  
 TEL +47 91 77 14 51. ole-petter@pollenmaritime.no

**RUSSIA:** JONACOR MARINE, PESOCHNAYA EMB., 18, ST PETERSBURG 197022,  
 TEL +7 (812) 702 47 70. info@jonacor-marine.ru

**SPAIN:** EUROSAIL SL, PORT BALIS, LOCAL 11, ES-08392 SANT ANDREU DE LLAVANERES  
 (BARCELONA). TEL 93 792 85 84. eurosail@eurosail.net

**SWITZERLAND:** BOOTSWERFT ROLF MÜLLER AG, BOTTIGHOFEN,  
 CH-8574 LENGWIL. TEL 071-688 41 41. rolf.mueller@hallberg-rassy.ch

**TURKEY:** PRIENE TURİZM YATÇILIK SAN. VE TİC. LTD. ŞTİ., CEMİLTÖPUZLU CAD. 104 A/16-17 B BLOK,  
 RAGIP PASA KORUSU 34728 CADDEBOSTAN, İSTANBUL TEL: +90 216 4677100. priene@arti-d.com

**UK:** TRANSWORLD YACHTS SAILING LTD, HAMBLE POINT MARINA, SCHOOL LANE, HAMBLE,  
 SOUTHAMPTON SO31 4JD. TEL 023-80 45 60 69. enq@transworld-yachts.co.uk

**USA, CT:** Eastland Yachts Inc., 33 Pratt Street, Essex, CT 06426.  
 Tel 860-767-8224. eyi@eastlandyachts.com

**USA, MD:** FREE STATE YACHTS INC., HERRINGTON HARBOUR MARINA NORTH, P O Box 220,  
 DEALLE, MD 20751. TEL: 410-867-9022, 800-871-1333 sales@freestateyachts.com

**USA, WA:** SWIFTSURE YACHTS, 2500 WESTLAKE AVE. N., SUITE F, SEATTLE WA 98109  
 TEL 206 378 1110. info@swiftsureyachts.com www.swiftsureyachts.com